

LEVEL 33 Office Building 2 Southbank Boulevard

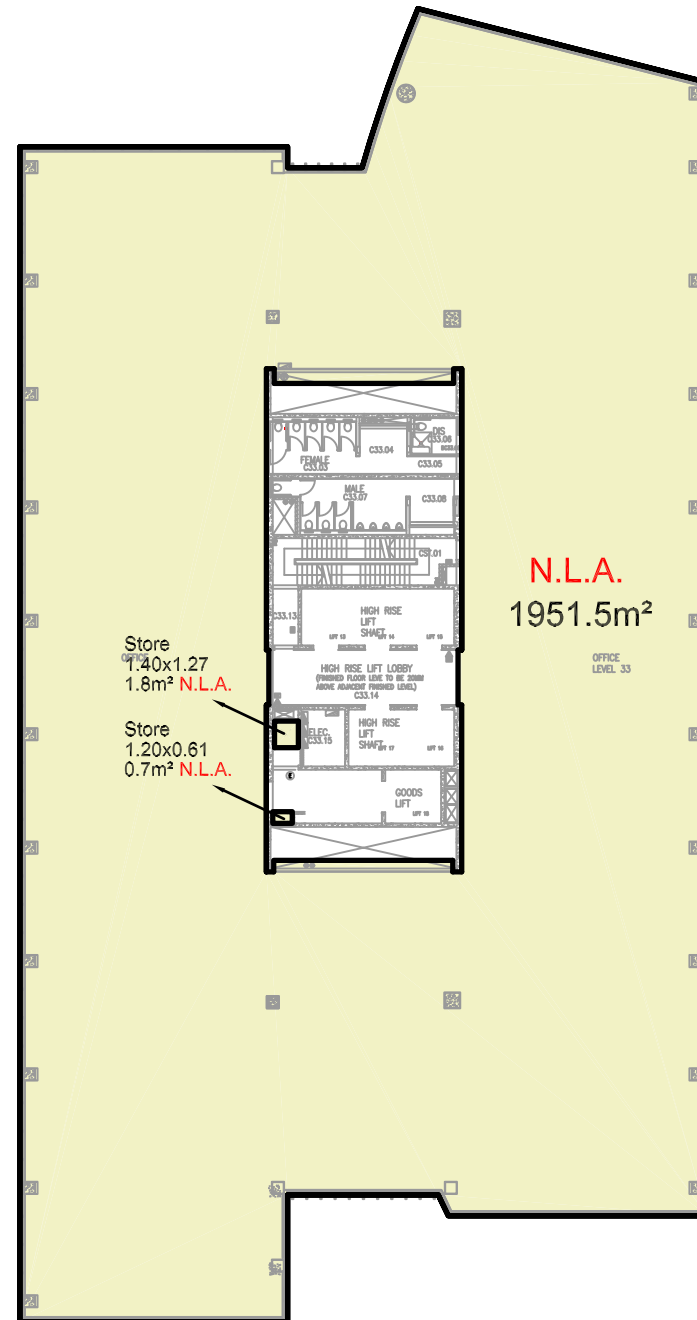
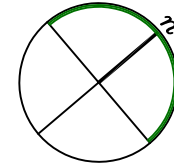

NOTES

Area and tenancy boundaries have been measured in accordance with the 'Property Council of Australia Method of Measurement for Lettable Area' March 1997 edition

Part 3 - Net Lettable Area (N.L.A.)

This plan should be read in conjunction with the written report
CAD REF: 303800PE.DWG March 2005

Bosco Jonson Pty Ltd

A.B.N 95 282 532 642

P.O. Box 243, South Melbourne, Vic 3205

71 Palmerston Crescent South Melbourne

Vic 3205 Australia DX 20524 Emerald Hill

Tel 03) 9699 1400 Fax 03) 9699 5992

